

ZS4000-2116 | EMC power coupling

itec[®] (Series 615), socket, straight, male, 12-pin



Electrical data	
Rated voltage (signal/24V)	63 V AC/DC
Rated current (signal/24V)	5 A max.
Rated impulse voltage (signal/24V)	1.5 kV
Contact resistance	< 5 mΩ
Mechanical data	
Accessories type	Connectors/Cables
Installation size	itec [®] (Series 615)
Connector type	socket
Configuration	straight
Contact type	male
Number of positions (face)	12-pin
Wire termination	crimp connection
Mating cycles	500
Way of locking	bayonet
Weight per piece	0.027 kg (0.0595 lb)
Body color	black, similar to RAL 9011

Body material	zinc diecast/plastic
Seal	FKM
Clamp ring	plastic
Contact carrier material	PBT, PA, UL 94 V-0
Contact material	brass/gold plated
Environmental data	
Special features	Max. height for operation 2000 m
Ambient temperature (operation)	-20...+130°C, -4...+266°F
Protection rating	IP66/67 in screwed condition
Pollution level	3 (according to VDE 0110/EN61984 part 6.19.2.2)
Overvoltage category	3 (according to VDE 0110/EN61984 part 6.19.2.2)

Dimensions

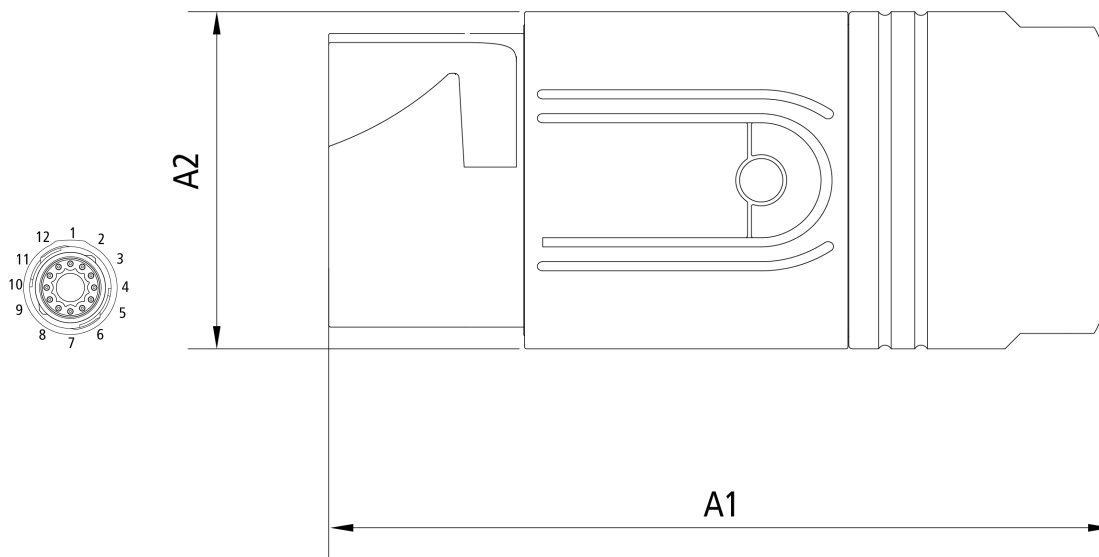

A1	44.00 mm
A2	19.00 mm

Notes

- Illustrations similar

Ordering information

ZS4000-2116 EMC power coupling, itec® (Series 615), socket, straight, male, 12-pin

Beckhoff®, TwinCAT®, TwinCAT/BSD®, TC/BSD®, EtherCAT®, EtherCAT G®, EtherCAT G10®, EtherCAT P®, Safety over EtherCAT®, TwinSAFE®, XFC®, XTS® and XPlanar® are registered trademarks of and licensed by Beckhoff Automation GmbH. Other designations used in this publication may be trademarks whose use by third parties for their own purposes could violate the rights of the owners.

© Beckhoff Automation GmbH & Co. KG 02/2024

The information provided in this brochure contains merely general descriptions or characteristics of performance which in case of actual application do not always apply as described or which may change as a result of further development of the products. An obligation to provide the respective characteristics shall only exist if expressly agreed in the terms of contract.